

TRIDEL®
BUILT FOR LIFE



rêve
KING WEST

Bève, a new condominium community at Front & Bathurst. Set amidst Toronto's most irresistible selection of shopping, dining, nightlife, recreation and cultural attractions. A bold architectural statement that says as much about where you live as how you live. Welcome home. In comfort, style and Tridel.





DOWER

BROKERAGE

South elevation.



North elevation.



VER
KERAGE



Rêve Club



- 01 Party Lounge
- 02 Meeting Room
- 03 Lounge
- 04 Billiards Room
- 05 Theatre
- 06 Main Lobby
- 07 Front Entrance
- 08 Yoga Centre
- 09 Change Rooms
- 10 Sauna Area
- 11 Wellness Centre

FRONT STREET WEST



NIAGARA STREET



Rêve Master Plan



The newest King West landmark.

LANDPOWER
REAL ESTATE LTD. BROKERAGE

Location

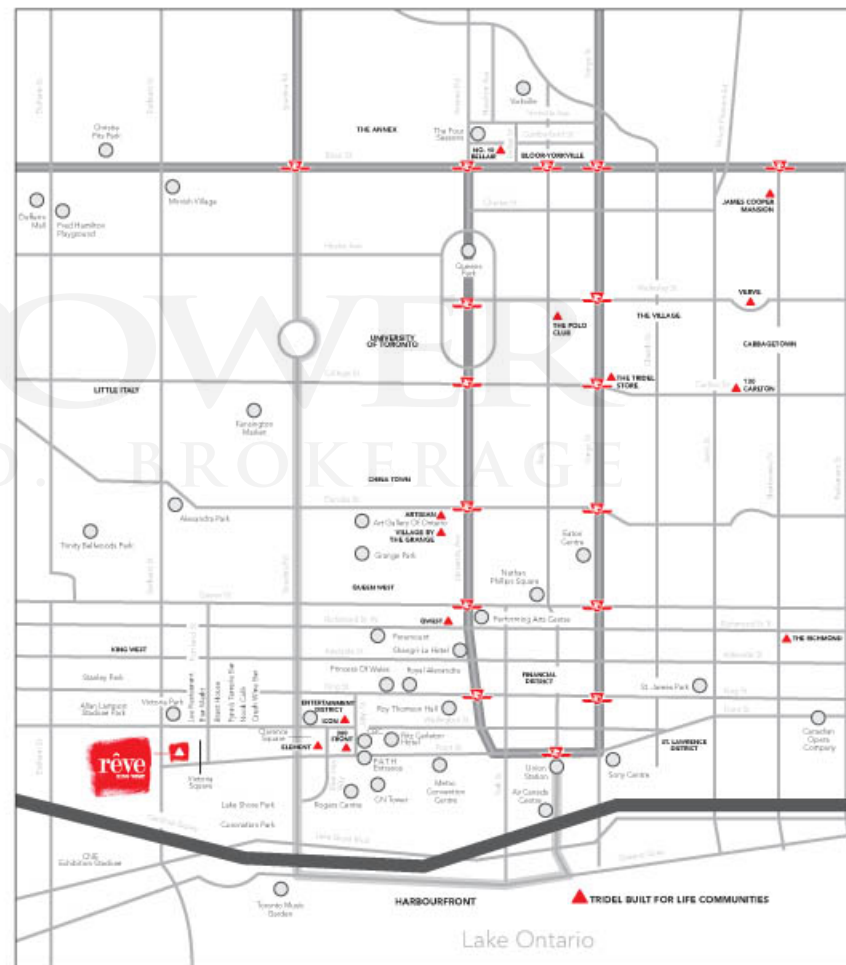



rêve
KING WEST

LAPOW
REAL STATE LTD. BROKERAGE

PRICE LIST

Suite	Design Type	Exposure	Floor	Starting Price* (From lowest floor available)	Approximate Square Feet	Estimated Maintenance Fee per month**	Estimated*** Property Tax per month
STUDIO							
ST1	Studio	N	3	\$199,000	435	\$230.55	\$141.75
ST2	Studio	W	3	\$209,000	475	\$251.75	\$148.87
ST4	Studio	N	2	\$249,000	565	\$299.45	\$177.37
1 BEDROOM & 1 BEDROOM + DEN							
1A	1 Bedroom	E	2	\$234,000	490	\$259.70	\$166.68
1B	1 Bedroom	W	3	\$230,000	495	\$262.35	\$163.83
1B1	1 Bedroom	W	3	\$235,000	500	\$265.00	\$167.39
1C	1 Bedroom	E	2	\$249,000	500	\$265.00	\$177.37
1D	1 Bedroom	W	3	\$250,000	540	\$286.20	\$178.08
1D1	1 Bedroom	W	3	\$240,000	505	\$267.65	\$170.96
1E	1 Bedroom	E	2	\$249,000	550	\$291.50	\$177.37
1E1	1 Bedroom	E	2	\$254,000	560	\$296.80	\$180.93
1F	1 Bedroom	E	3	\$230,000	555	\$294.15	\$163.83
1G	1 Bedroom	W	2	\$237,000	555	\$294.15	\$168.82
1H	1 Bedroom	E	3	\$250,000	550	\$291.50	\$178.08
1J+D	1 Bedroom plus Den	E	2	\$309,000	645	\$341.85	\$220.11
1K+D				\$341,000	650	\$345	\$225
2 & 3 BEDROOMS							
2A+D	2 Bedrooms plus 2 Baths	S	3	\$369,000	770	\$408.10	\$262.85
2C+D	2 Bedrooms plus 2 Baths	N	6	\$417,000	885	\$469.05	\$297.04
3A	3 Bedrooms plus 2 Baths	S/N	4	\$460,000	970	\$514.10	\$327.67
3B	3 Bedrooms plus 2 Baths	S/N	3	\$494,000	1060	\$561.80	\$351.88

\$1,000 floor premium, excluding PH and Terrace

STUDIO 1

A starter suite with loads of potential, this unique space lets you live in comfort to help you get the most out of life.

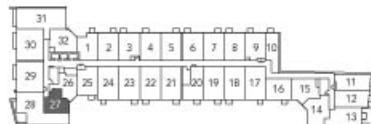

3RD & 4TH FLOOR



5TH - 6TH FLOOR

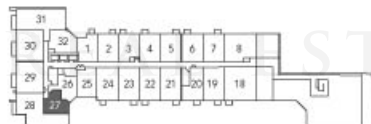

10TH FLOOR

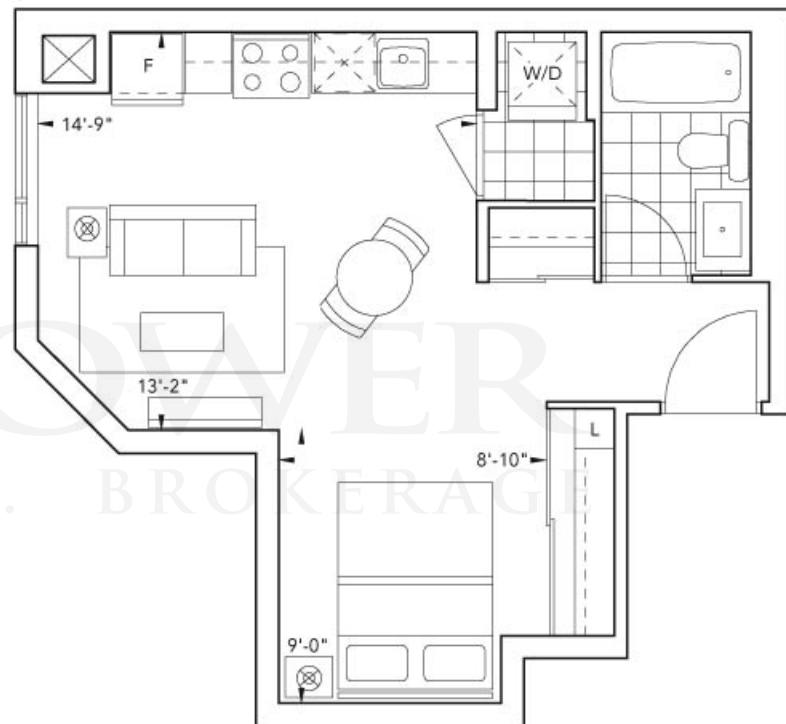

All dimensions are approximate and subject to normal construction variations. Dimensions may exceed the usable floor area. Show and/or photos are subject to change without notice. Furniture is depicted for illustrative purposes only and does not necessarily reflect the actual layout for this suite. To see an actual unit please E-MAIL: October 1, 2018

This cheery studio features an efficient configuration that offers an excellent quality of space for the kitchen, living room and dining room. The roomy stand-up shower in the bathroom is another example of this suite's intelligent use of space.

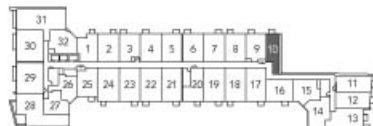

3RD & 4TH FLOOR



5TH - 6TH FLOOR



AND POWER REAL ESTATE LTD. BROKERAGE

STUDIO 2

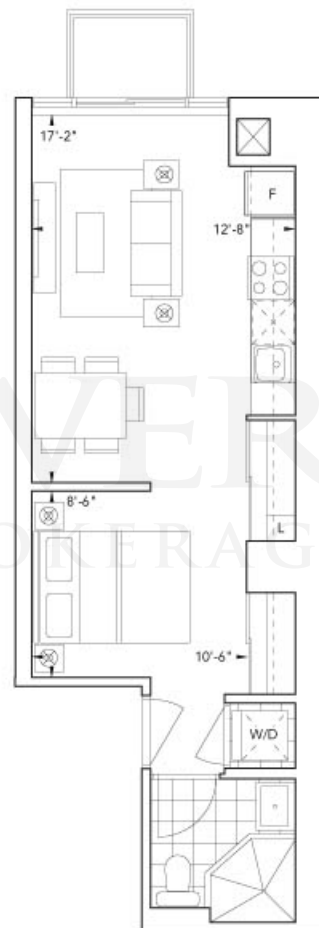

All dimensions are approximate and subject to normal construction variations. Dimensions may exceed the usable floor area. Show and floor plans are subject to change without notice. Furniture is designed for illustrative purposes only and does not necessarily reflect the actual layout for this suite. To see an actual unit please call 416-491-1234.

Enjoy life in this inviting studio with its relaxing soaker tub in the bathroom. A half-wall between the sleeping and living areas offers excellent privacy while allowing for a healthy flow of natural light.

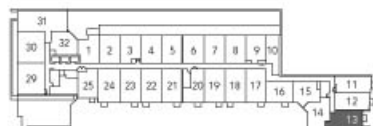

2ND FLOOR



3RD & 4TH FLOOR

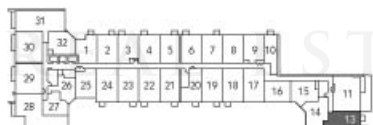

5TH - 8TH FLOOR



STUDIO 4

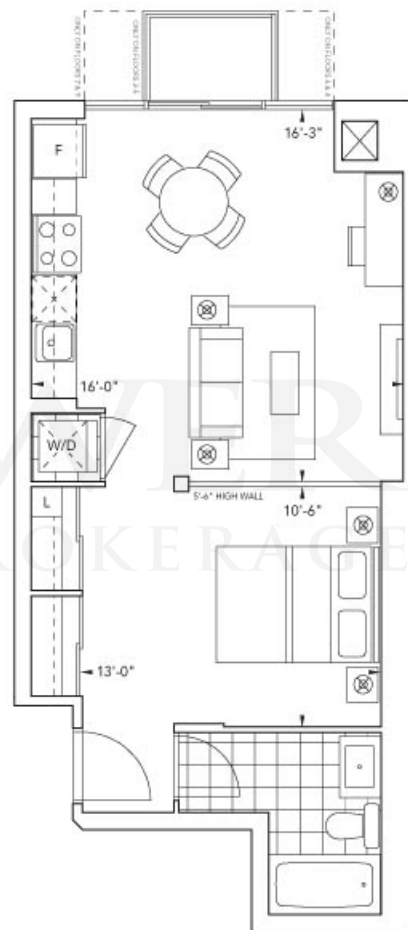

All dimensions are approximate and subject to normal construction variations. Dimensions may exceed the usable floor area. Show and/or floor plans are subject to change without notice. Furniture is depicted for illustrative purposes only and does not necessarily reflect the actual layout for this unit. To see an actual unit please call 800-521-2289.

A dramatic front hallway and roomy bathroom mark this suite's entrance, while the kitchen, dining room and living room help you live in open-concept comfort.

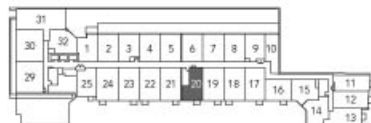

2ND FLOOR



3RD & 4TH FLOOR

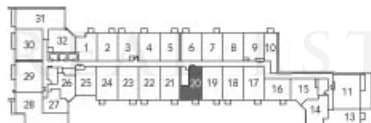

5TH - 6TH FLOOR

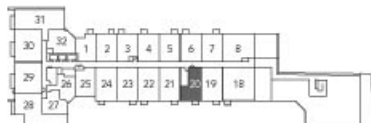

10TH FLOOR



1A

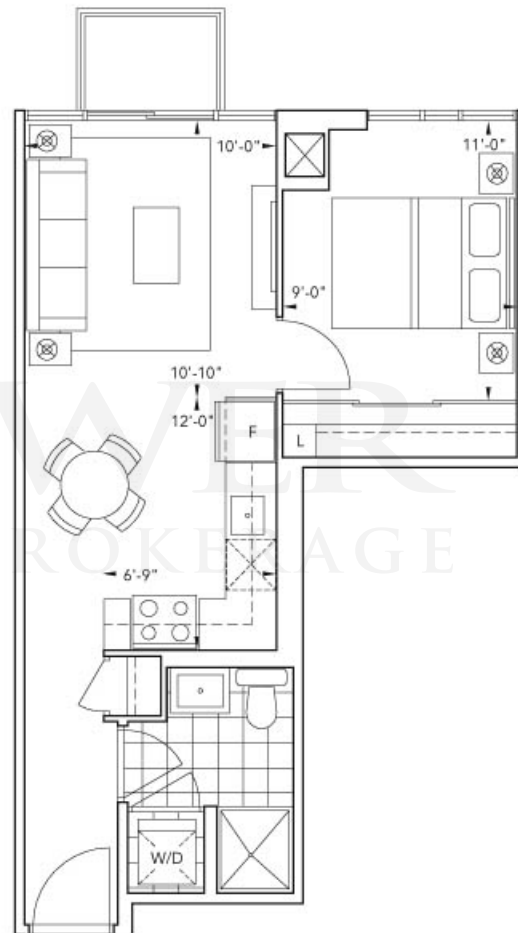

All dimensions are approximate and subject to normal construction variations. Dimensions may exceed the usable floor area. Show and/or fixtures are subject to change without notice. Furniture is depicted for illustrative purposes only and does not necessarily reflect the actual layout for the suite. To see an actual unit please E-MAIL: October 1, 2009

A large bedroom characterizes this suite's design, with pleasant floor-to-ceiling windows and ample closet space. The living and dining areas are also quite spacious, and the balcony off the living room offers additional space to relax.

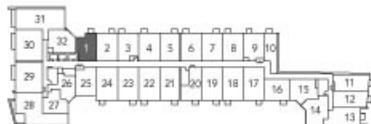

8TH & 4TH FLOOR

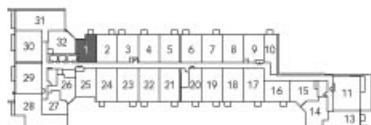

5TH - 9TH FLOOR



10TH FLOOR



11TH FLOOR



12TH FLOOR



PENTHOUSE



1B

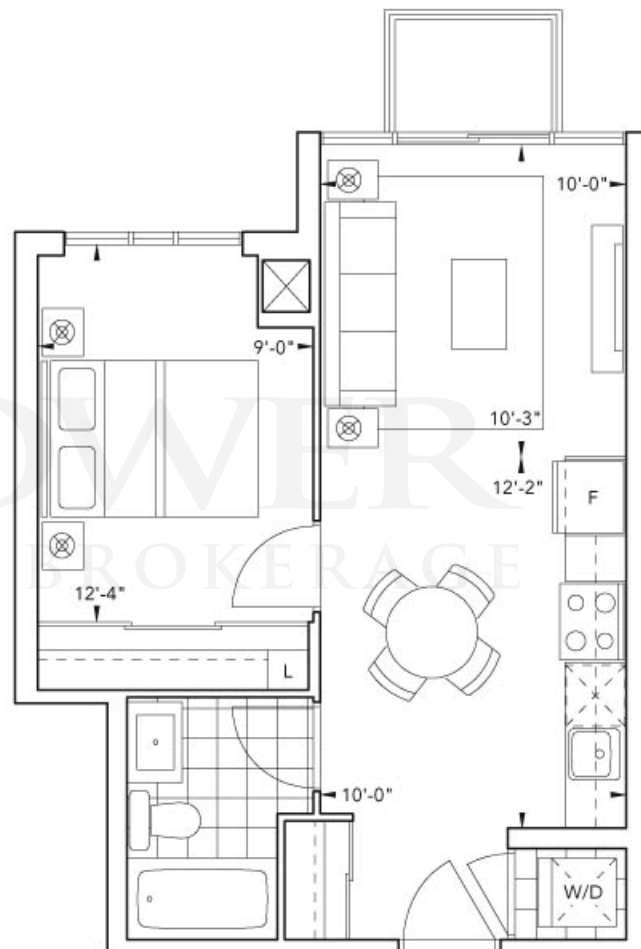

All dimensions are approximate and subject to normal construction variations. Dimensions may exceed the usable floor area. Show and floor plans are subject to change without notice. Furniture is depicted for illustrative purposes only and does not necessarily reflect the actual layout for the suite. To see an actual unit please E-MAIL: October 1, 2009

Natural light will flow into this suite in abundance, thanks to floor-to-ceiling windows dominating almost the entire east wall. The U-shaped kitchen offers excellent counter space, and creates a dynamic prep area.

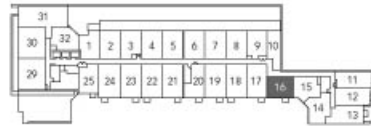

2ND FLOOR



3RD & 4TH FLOOR

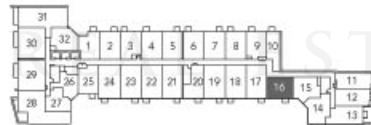

5TH - 10TH FLOOR

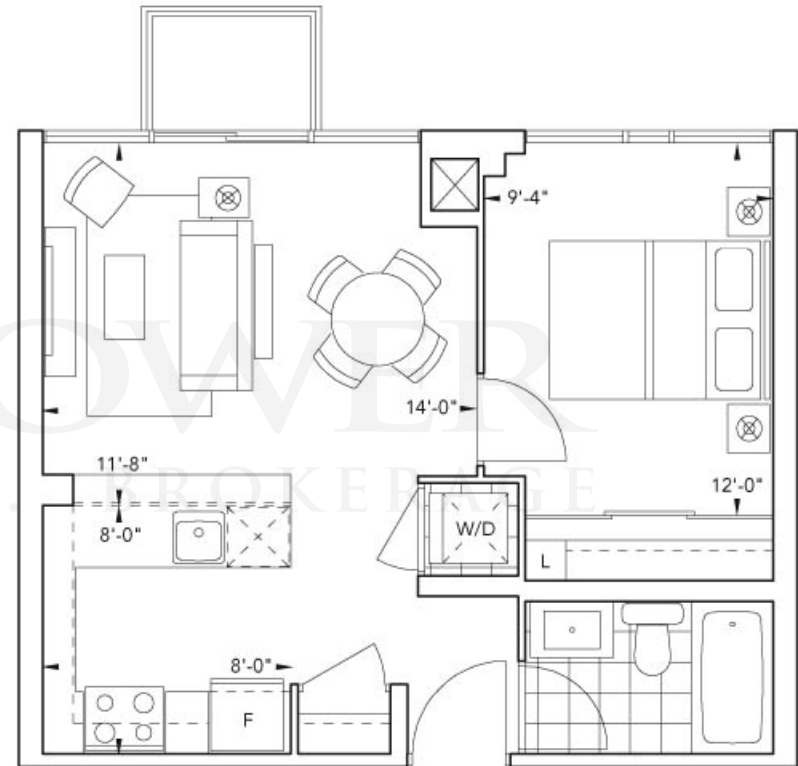

All dimensions are approximate and subject to normal construction variations. Dimensions may exceed the usable floor area. Show and/or fixtures are subject to change without notice. Furniture is depicted for illustrative purposes only and does not necessarily reflect the plan layout for this suite. To see an architect's plan, E&O © October 1, 2015

A natural relationship between the kitchen and the living and dining rooms establishes a harmonious living environment. The spacious bedroom offers ample space for bedroom furniture, and the closet offers enough storage space for a full-season wardrobe.

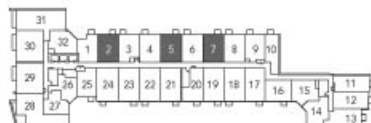

3RD & 4TH FLOOR



5TH - 6TH FLOOR



10TH FLOOR



11TH FLOOR



1D

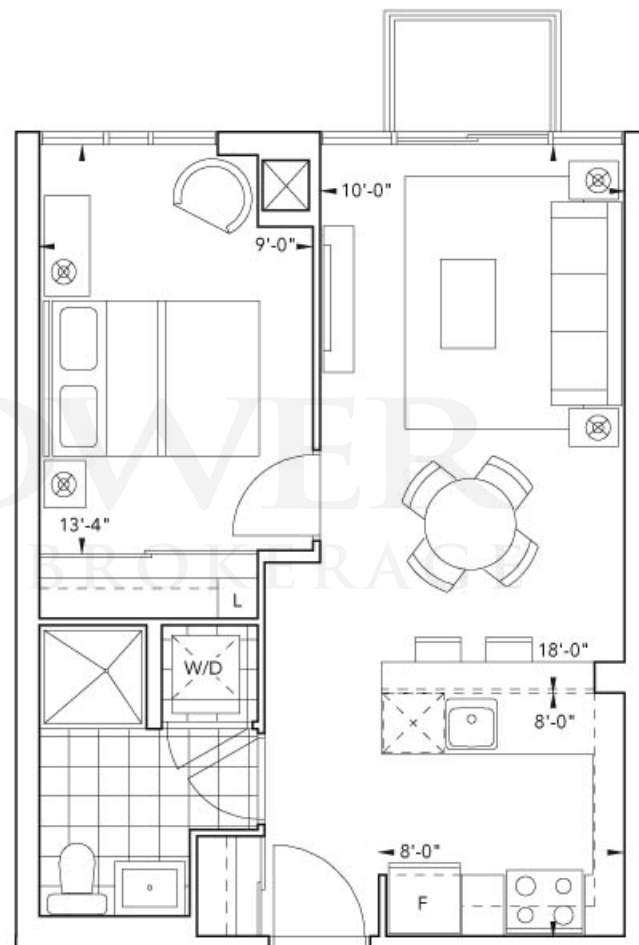

All dimensions are approximate and subject to normal construction variations. Dimensions may exceed the usability floor area. Show and model fixtures are subject to change without notice. Furniture is depicted for illustrative purposes only and does not necessarily reflect the actual layout for this unit. To see an actual unit please E-MAIL: October 1, 2018

With more-than-enough counter space in the kitchen, this suite will definitely appeal to the aspiring chef. A sliding door separating the bedroom from the living area is another exciting feature.

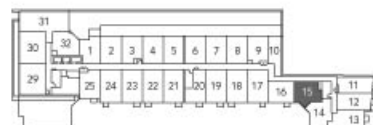

2ND FLOOR

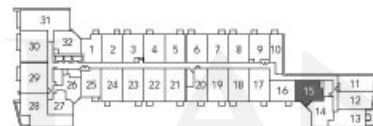

3RD & 4TH FLOOR

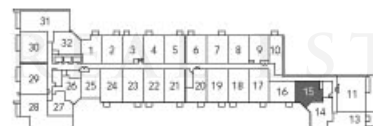

5TH - 6TH FLOOR

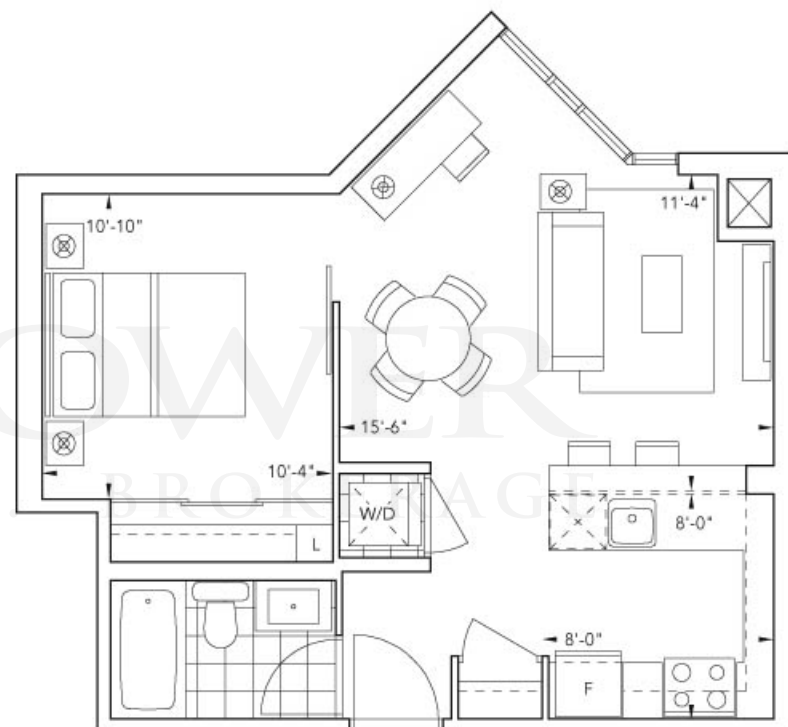

The comfortably sized bedroom in this suite offers lots of room for bedroom furnishings, and the large bank of windows helps complete the space. The charming mini breakfast bar attached to the kitchen is a great place for guests to relax while you prepare the evening's meal.

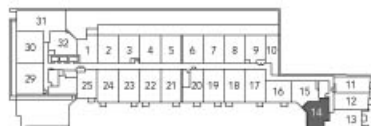

2ND FLOOR

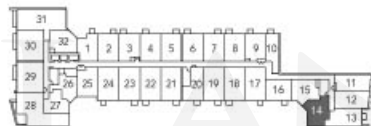

3RD & 4TH FLOOR

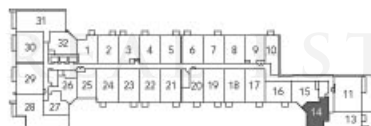

5TH - 8TH FLOOR

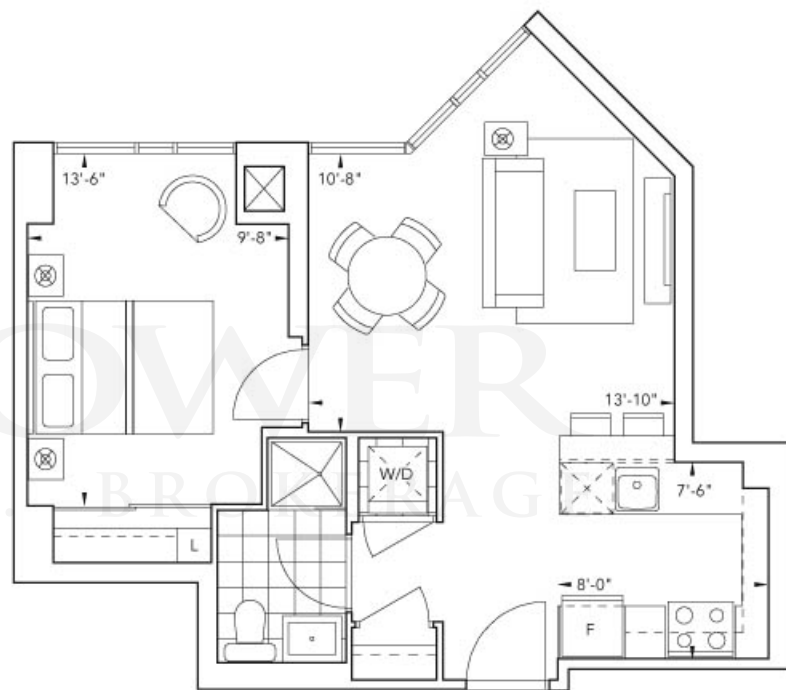

A unique layout marks the character of this inviting suite. Living areas seamlessly combine, while sliding frosted-glass doors to the bedroom offer an intimate sleeping space for a relaxing night's repose.

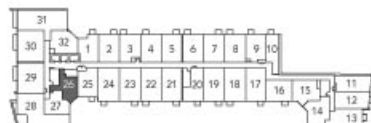

8TH & 4TH FLOOR



5TH - 9TH FLOOR

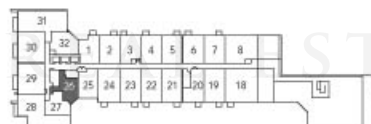

10TH FLOOR



11TH FLOOR

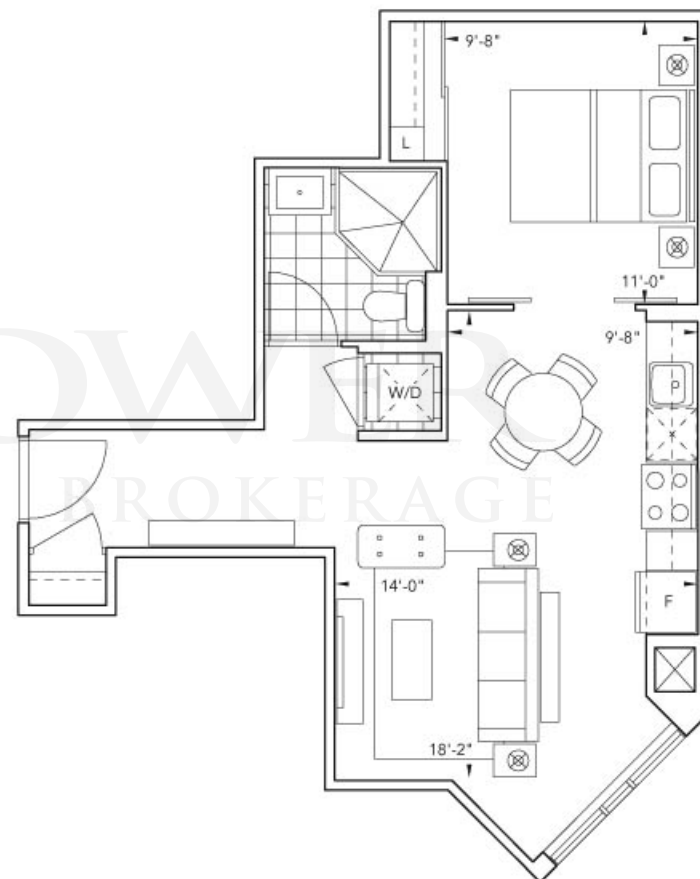

All dimensions are approximate and subject to normal construction variations. Dimensions may exceed the usable floor area. Show and/or model pictures are subject to change without notice. Furniture is depicted for illustrative purposes only and does not necessarily reflect the actual layout for this suite. To see an actual unit please E-MAIL: October 1, 2018

Take a step into this comfortable space and feel instantly at ease in the open-concept design. A frosted window built into the bedroom wall offers excellent seclusion for a peaceful night's rest.

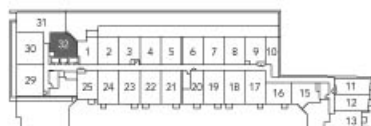

29TH FLOOR

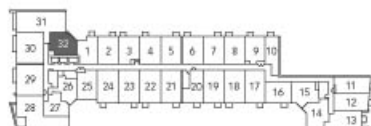

30TH & 31TH FLOOR



32TH - 33RD FLOOR

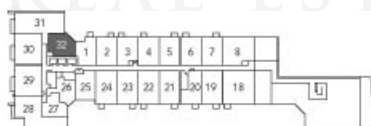

34TH FLOOR

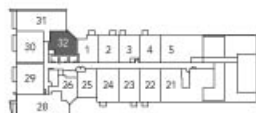

35TH FLOOR



36TH FLOOR



PENTHOUSE

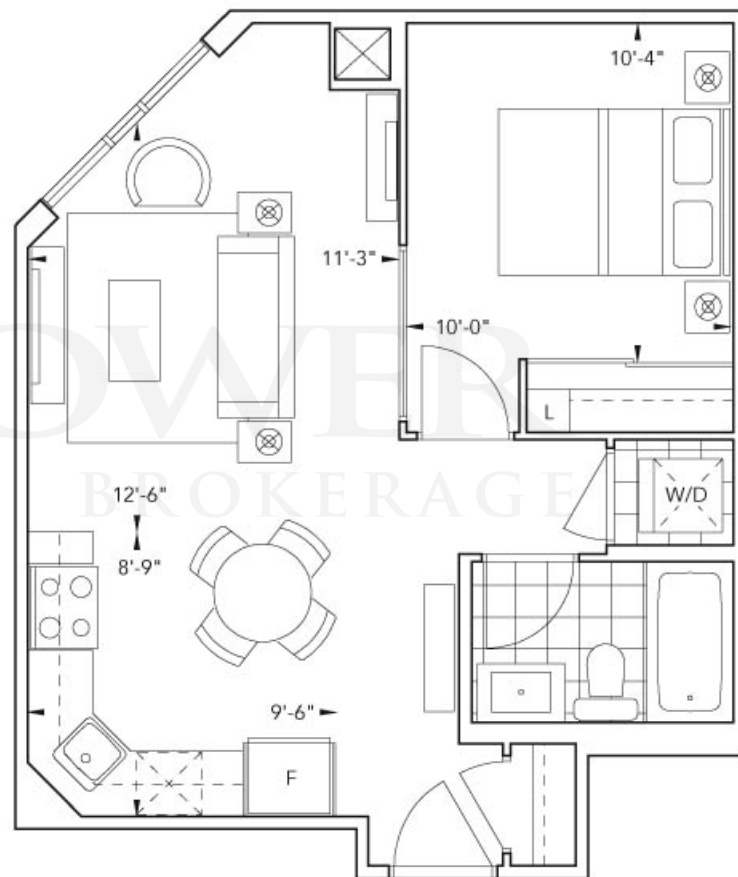

All dimensions are approximate and subject to normal construction variations. Dimensions may exceed the overall floor area. Show and model pictures are subject to change without notice. Furniture is designed for illustrative purposes only and does not necessarily reflect the actual layout for this unit. To be an architect/interior designer. E.A.O.C. October 1, 2018

Living and dining areas naturally flow together, offering a seamless transition from the dinner table to the couch. A generously sized closet in the bedroom offers enough space for one wardrobe... even two.

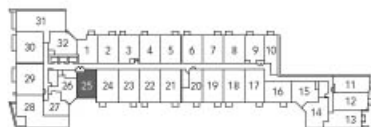

3RD & 4TH FLOOR

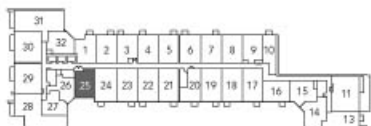

5TH - 9TH FLOOR

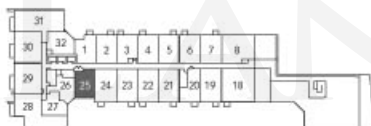

10TH FLOOR



11TH FLOOR



12TH FLOOR



PENTHOUSE

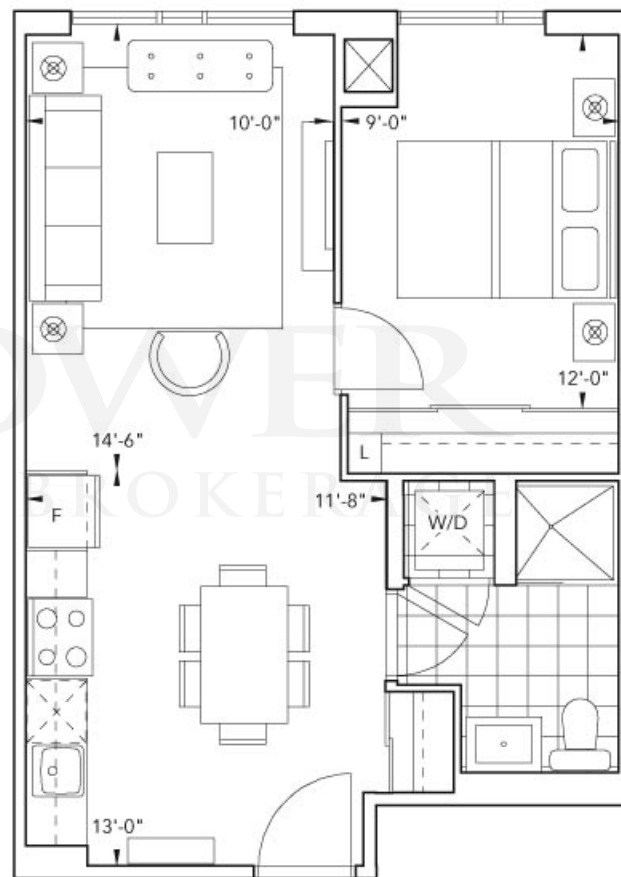

All dimensions are approximate and subject to normal construction variations. Dimensions may exceed the usable floor area. Show and floor plans are subject to change without notice. Furniture is depicted for illustrative purposes only and does not necessarily reflect the actual layout for this unit. To see an actual unit, please call 800-528-1200.

Live in comfort and style in this bedroom-plus-den suite. The bedroom is pleasantly spacious, and has ample closet space. The den is a nice extra, creating additional space for a home office or reading room.

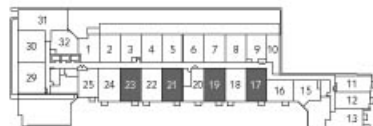

2ND FLOOR

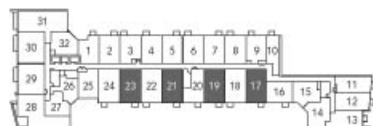

3RD & 4TH FLOOR



5TH - 8TH FLOOR

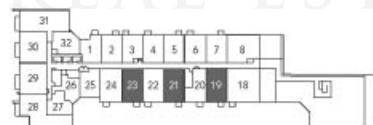

9TH FLOOR



11TH FLOOR



1J+D

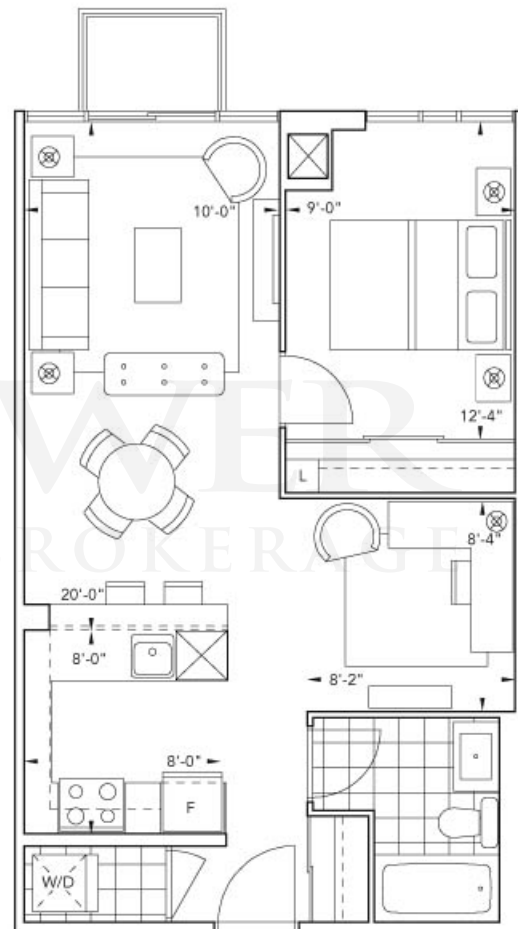

All dimensions are approximate and subject to normal construction variations. Dimensions may exceed the usable floor area. Show and grid positions subject to change without notice. Furniture is depicted for illustrative purposes only and does not necessarily reflect the actual layout for this unit. To be used in conjunction with S.A.O.C. Circular 1, 2009.

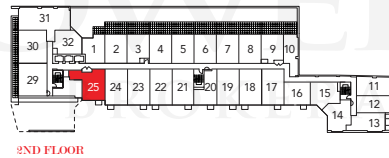
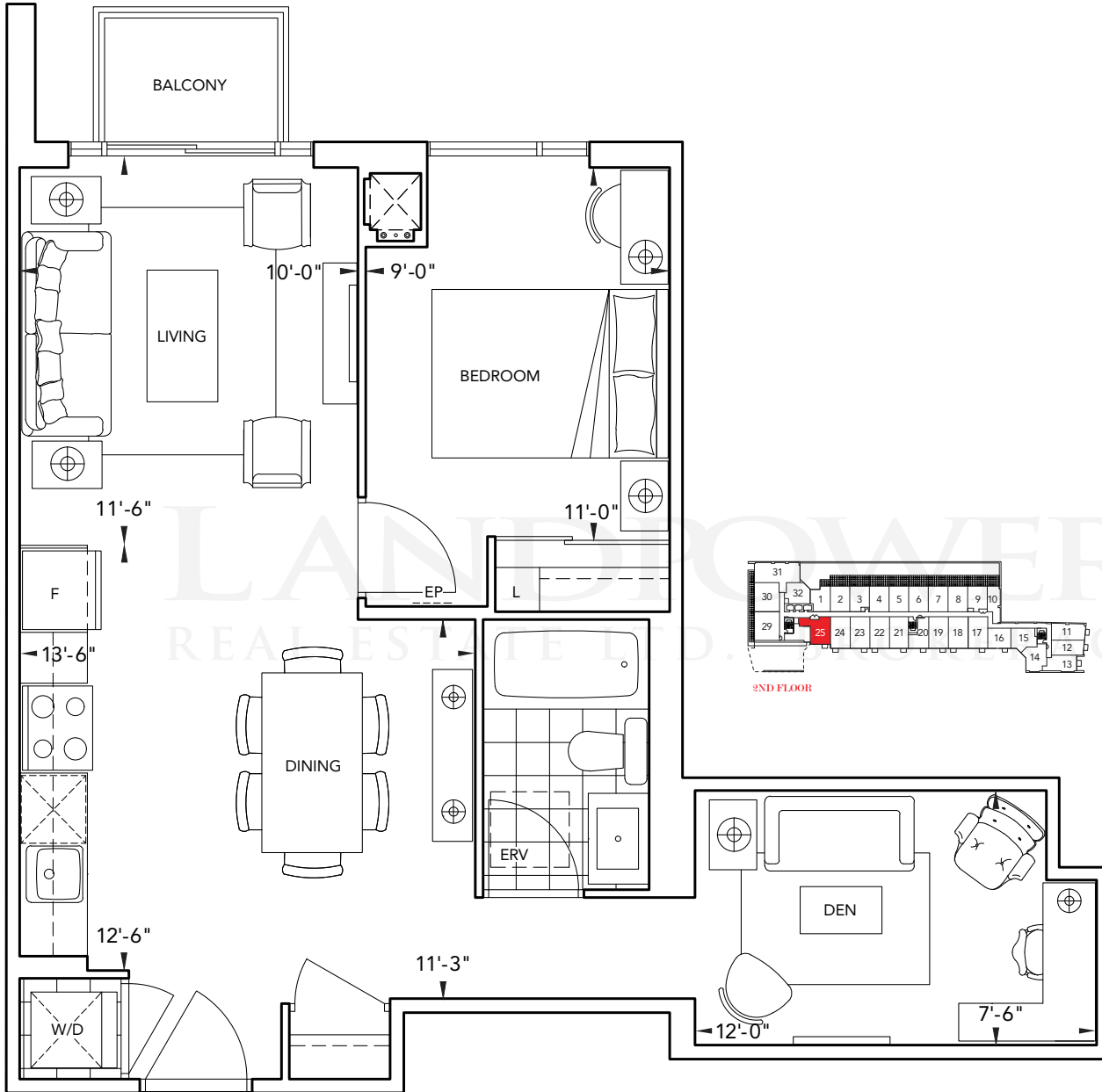

Tridel, for the fourth consecutive year, has been ranked number one in the 2009 J.D. Power and Associates New Condominium Builder Customer Satisfaction Study in the GTA.



2010 Ontario High-Rise Builder of the Year by Tarion.



2010 High-Rise Green Builder of the Year by BILD.



2009 Home Builder of the Year by the Ontario Home Builders' Association.



This open-concept 2-bedroom design maximizes its use of space with a den, spacious living room, central dining and 2 generous bathrooms. The large balcony offers even more space to relax and entertain.

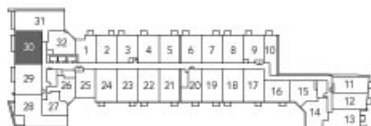

3RD & 4TH FLOOR

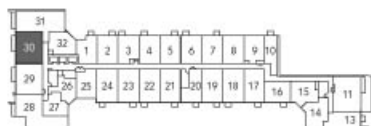

5TH - 8TH FLOOR

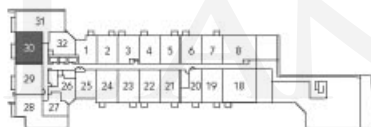

10TH FLOOR



11TH FLOOR



12TH FLOOR



PENTHOUSE



2A+D

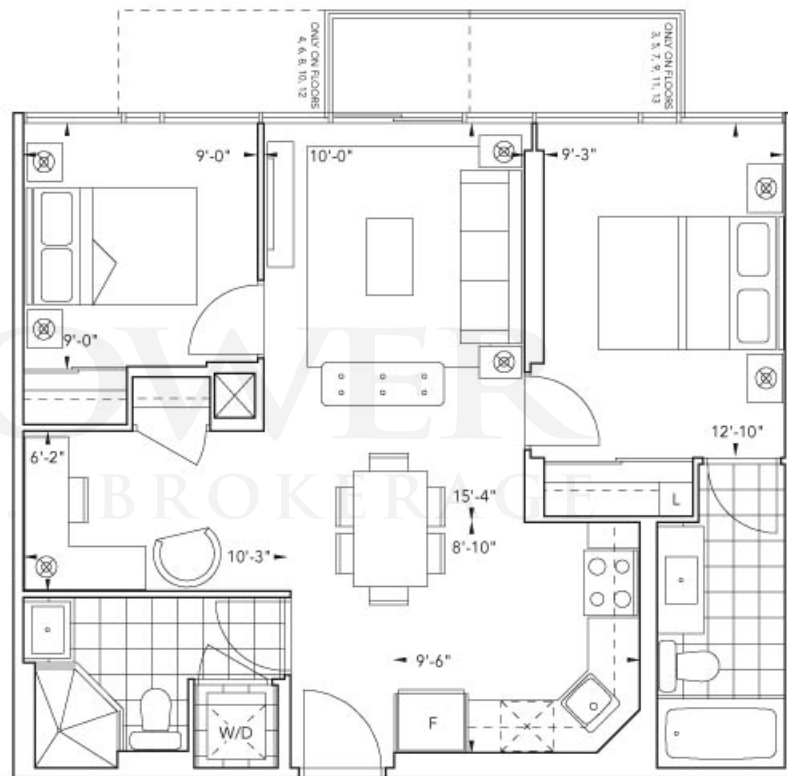

All dimensions are approximate and subject to normal construction variations. Dimensions may exceed the usable floor area. Show and model pictures are subject to change without notice. Furniture is designed for illustrative purposes only and does not necessarily reflect the actual layout for this unit. To be an architect/interior designer. E.A.O.C. October 1, 2018

2 bedrooms with an ensuite master bathroom. A generously sized kitchen. Ample living space including a den. A sizable balcony. And window after window offering an abundance of natural light throughout the home. This suite has so much to offer, it's sure to sell out quickly.

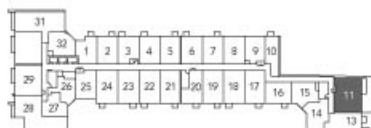

6TH - 9TH FLOOR



LANDPOWER
REAL ESTATE LTD. BROKERAGE

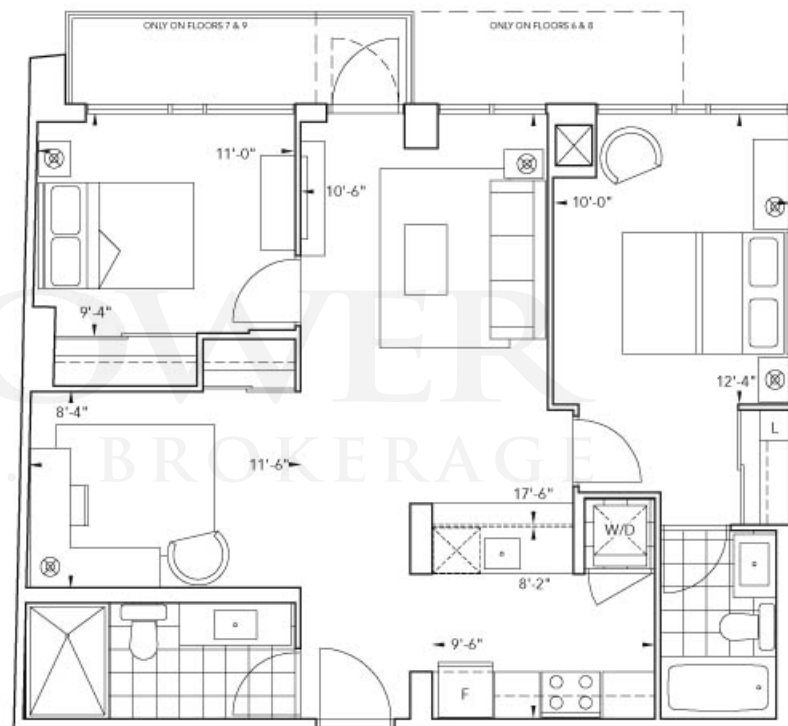

With its dynamic layout, this 3-bedroom suite offers the perfect blend of privacy and sociability. The immense master bedroom could be a suite unto itself, with a roomy walk-in closet and inviting ensuite bathroom. With windows on both the north and south ends of the suite, this promises to be a wonderfully lit space.

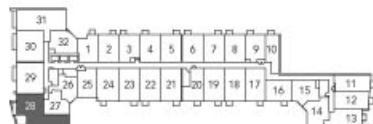

4TH FLOOR

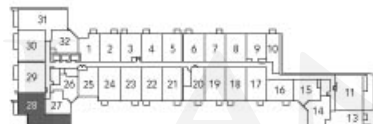

5TH - 9TH FLOOR

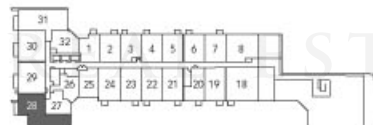

10TH FLOOR

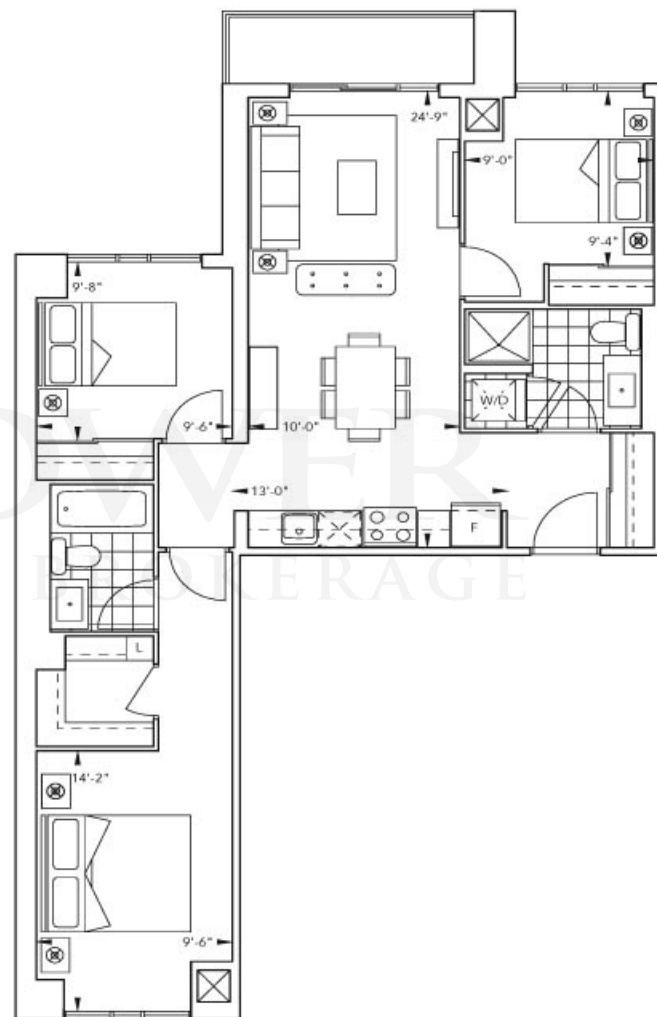

All dimensions are approximate and subject to normal construction variances. Dimensions may exceed the usability floor area. There are no standard fixtures included in design without notes. Furniture is displayed for illustrative purposes only and does not necessarily reflect the actual layout for the suite. To view an actual floor plan, visit www.360.com or call 1-800-360-3600.

This 3-bedroom suite is intelligently arranged to maximize comfort. The master bedroom features a walk-in closet and ensuite bathroom, and the other 2 bedrooms are quite generous. The living and dining areas offer ample space, while the balcony could become the ultimate living and dining destination during warm summer months.

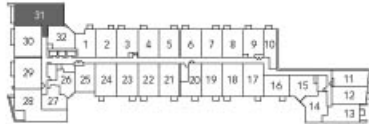

3RD & 4TH FLOOR



5TH - 9TH FLOOR

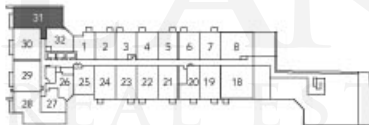

10TH FLOOR



11TH FLOOR



12TH FLOOR



PENTHOUSE

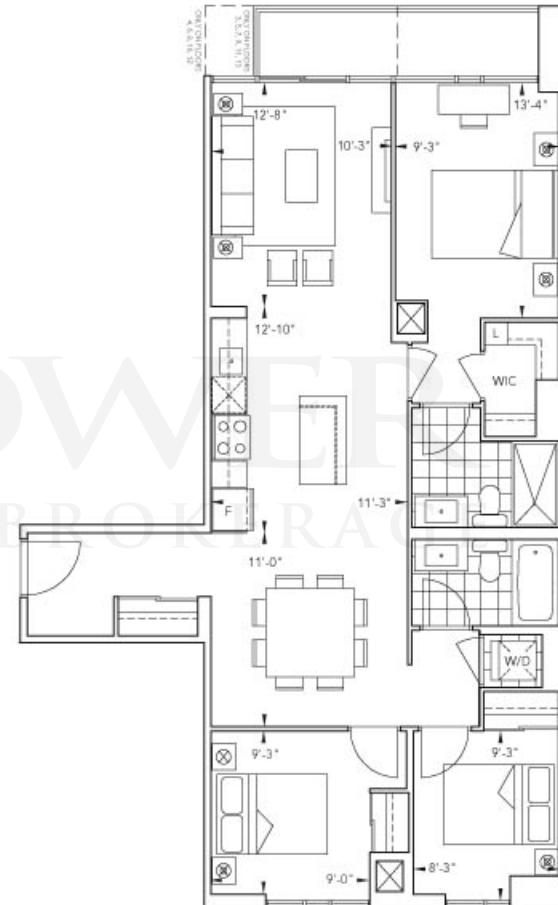

All dimensions are approximate and subject to normal construction variations. Dimensions may increase from available floor area. Show and/or Photos subject to change without notice. Furniture is depicted for illustrative purposes only and does not necessarily reflect the actual layout for the suite. To be an actual unit/level. S.A.O.C. October 1, 2009



LANE
REAL ESTATE

ER
RAGE

DREAM
COLLECTION

rêve
KING WEST

tridel.com

This loft takes open-concept living to the next level, with the living and dining area naturally flowing towards the kitchen on the main level and the bedroom on the second level cheerfully integrating with the den, walk-in closet and ensuite bathroom.

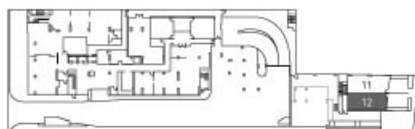

GROUND FLOOR



END FLOOR



LANDPOWER REAL ESTATE LTD BROKERAGE

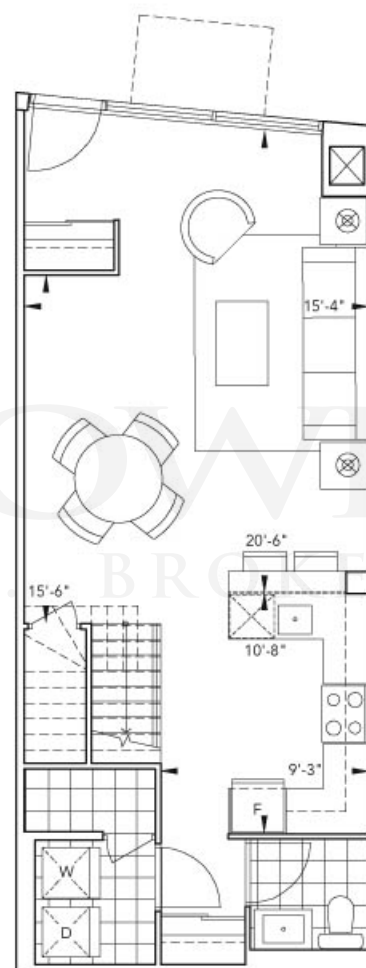

GROUND FLOOR

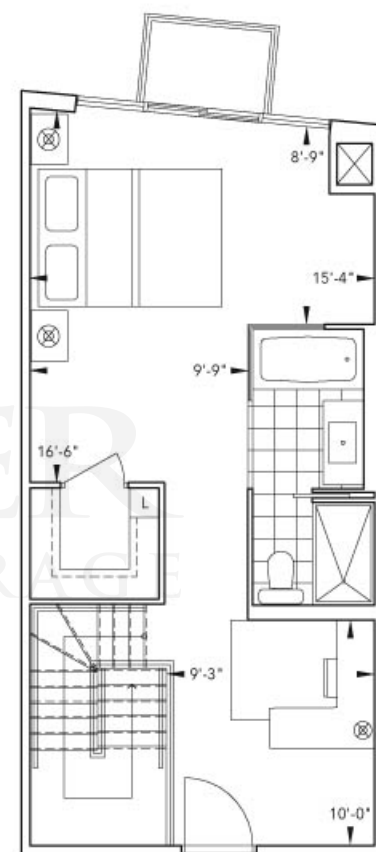

END FLOOR

There is so much to like about this attractive 1-bedroom loft, from the open-concept layout to the balcony off the bedroom, the U-shaped kitchen with abundant counter space and the second-floor bathroom with both a soaker tub and stand-up shower.

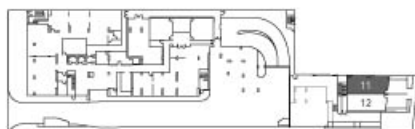

GROUND FLOOR

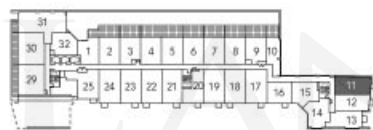

2ND FLOOR

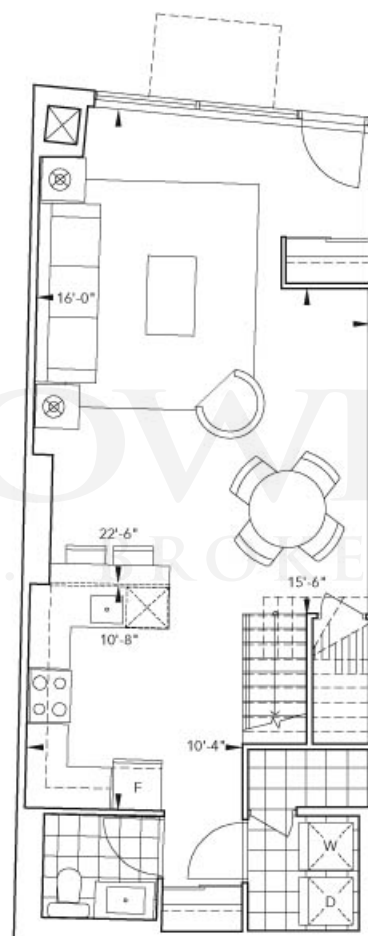

GROUND FLOOR

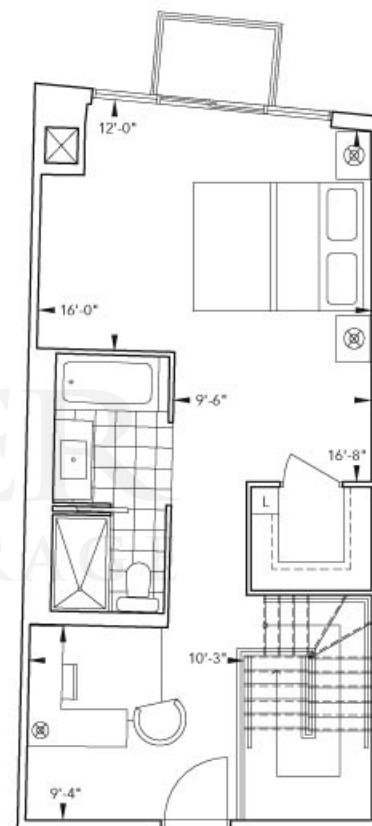

2ND FLOOR

As the only studio design with a terrace, this suite combines a warm and cozy interior with a highly desirable exterior. After moving into this suite, your next big purchase will be the patio furniture.

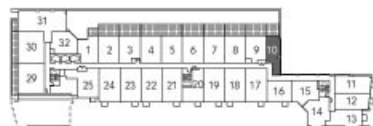

2ND FLOOR



LANDPOWER
REAL ESTATE LTD. BROKERAGE

STUDIO 2+T

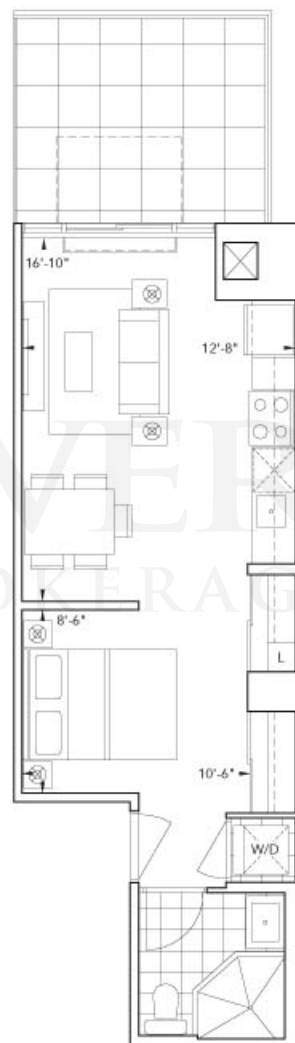

All dimensions are approximate and subject to normal construction variations. Dimensions may increase from available floor area. Show and/or photos are subject to change without notice. Furniture is displayed for illustrative purposes only and does not necessarily reflect the actual layout for the suite. Photos are not published E.S.C.E. October 16, 2015

1B+T

Indoor comfort meets outdoor splendour. This well-lit 1-bedroom suite features soaring windows in the bedroom and living room, and sliding doors opening up to a generously sized terrace.

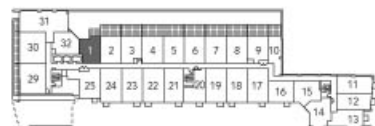

2ND FLOOR



LANDPOWER
REAL ESTATE LTD. BROKERAGE

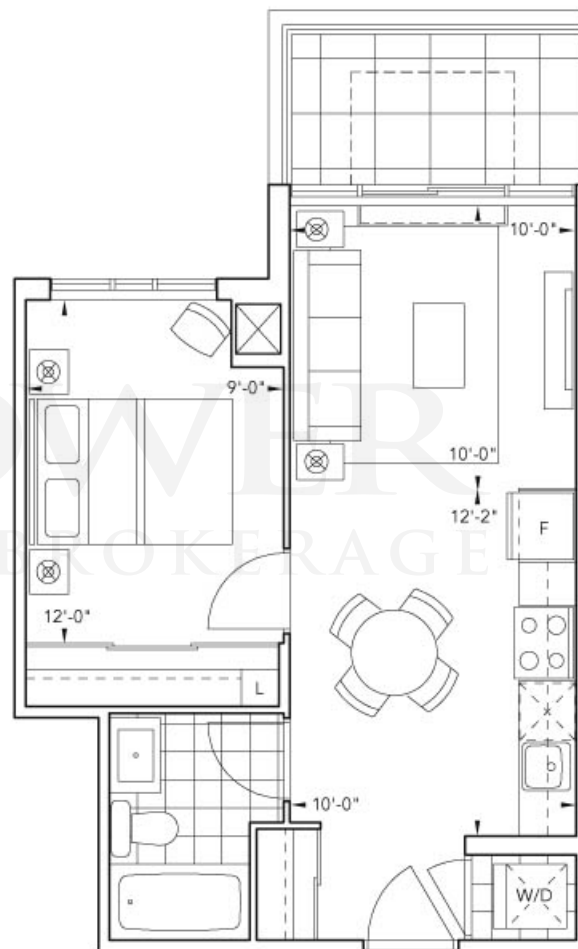

All dimensions are approximate and subject to normal construction variations. Dimensions may exceed the usable floor area. Show and/or photos are subject to change without notice. Furniture is depicted for illustrative purposes only and does not necessarily reflect the actual layout for the suite. Photos are not published E.S.C.E. October 16, 2019

An enormous terrace is an obvious highlight of this stylish 1-bedroom design. You also have a harmonious integration of living and dining areas, and an amply sized bedroom.

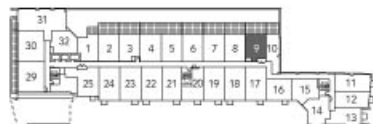

2ND FLOOR



LANDPOWER
REAL ESTATE LTD. BROKERAGE

1B1+T

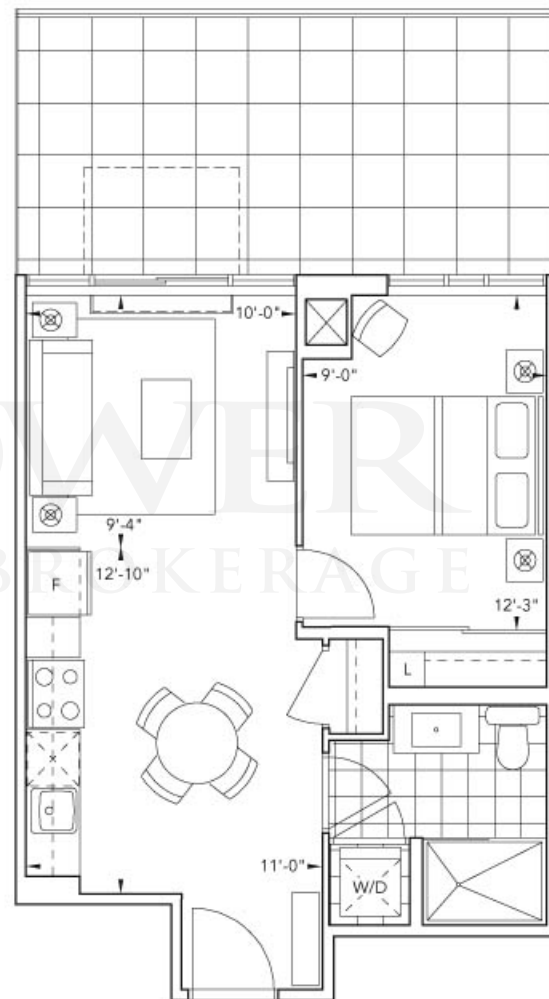

All dimensions are approximate and subject to normal construction variations. Dimensions may increase from outside floor area. Show and/or fixtures subject to change without notice. Furniture is depicted for illustrative purposes only and does not necessarily reflect the actual floor plan for the unit. Sales are sold pursuant to E.S.C.E. October 16, 2015

A kitchen with loads of counter space plus a breakfast bar. A pleasantly sized bedroom. Open-concept living and dining areas. And a spacious terrace. What more could you ask for in a 1-bedroom design?

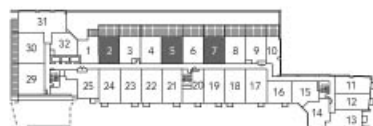

2ND FLOOR



LANDPOWER
REAL ESTATE LTD. BROKERAGE

1D+T

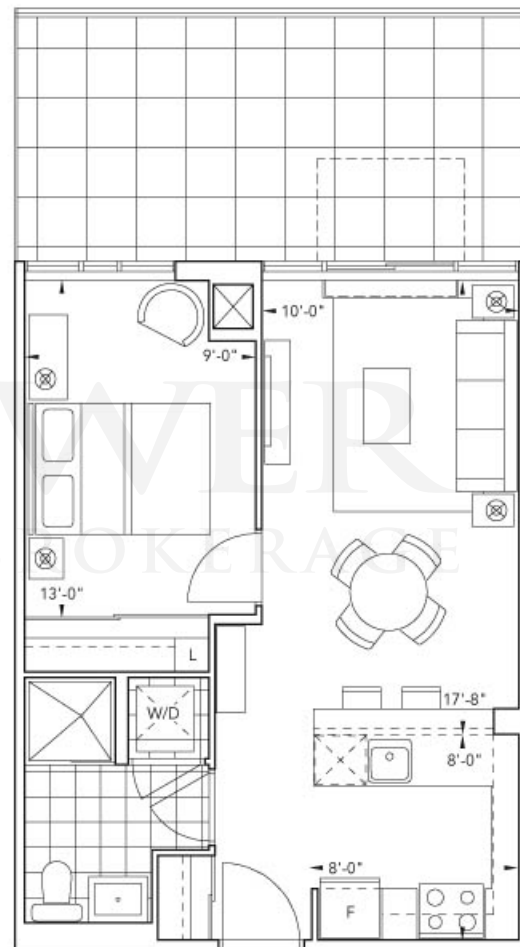

All dimensions are approximate and subject to normal construction variations. Dimensions may increase from utility floor area. Show and model features are subject to change without notice. Furniture is depicted for illustrative purposes only and does not necessarily reflect the actual layout for the unit. Photos are not intended to show the unit as it is. © 2011, October 16, 2011

You could create a culinary masterpiece in this suite's kitchen, with the intelligently located stove offering excellent preparation space on either side. A spacious living room and bedroom, and an equally spacious terrace, are other comforting benefits.

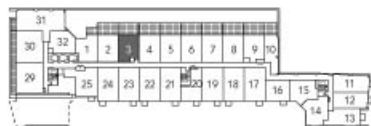

2ND FLOOR



LANDPOWER
REAL ESTATE LTD. BROKERAGE

1D1+T

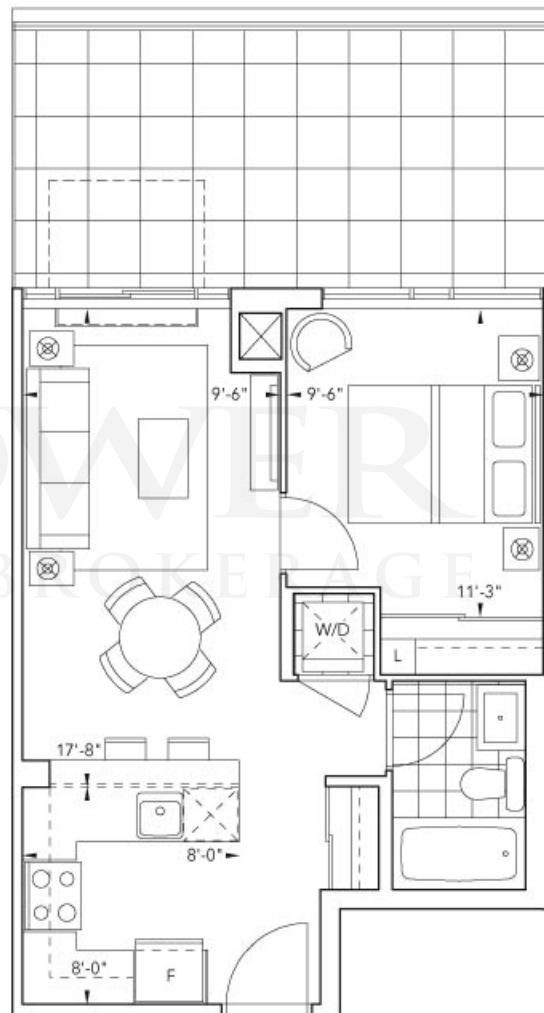

All dimensions are approximate and subject to normal construction variations. Dimensions may increase from visible floor area. Show and/or model furnished subject to change without notice. Furniture is depicted for illustrative purposes only and does not necessarily reflect the actual floorplan for the suite. Photos are not to scale. E.S.C. October 16, 2018

You get 2 bathrooms in this intelligently arranged 1-bedroom suite, including an ensuite bathroom in the bedroom. Opaque glass sliding doors mark the entrance to the bedroom, which provides excellent nighttime privacy and wonderful daytime brightness flowing from the exceptionally generous terrace.



12TH FLOOR



LANDPOWER
REAL ESTATE LTD. BROKERAGE

1L+T

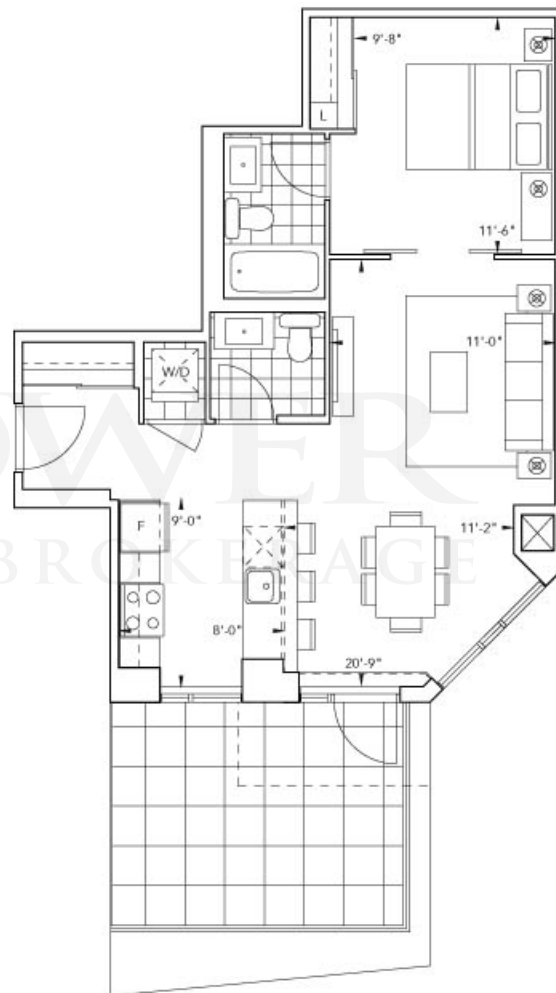

All dimensions are approximate and subject to normal construction variations. Dimensions may increase from visible floor area. Show and model fixtures subject to change without notice. Furniture is depicted for illustrative purposes only and does not necessarily reflect the actual layout for the unit. Photos are not to scale. © 2011, October 16, 2011

2A+DT

Expect to feel spoiled by all the natural light you will experience in this 2-bedroom design, with a virtual wall of glass on this home's south wall. The den is another value-added feature that gives you room for a computer desk and bookcases.

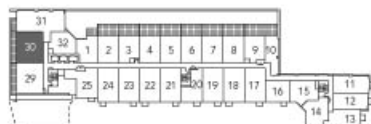

2ND FLOOR



LANDPOWER
REAL ESTATE LTD. BROKERAGE

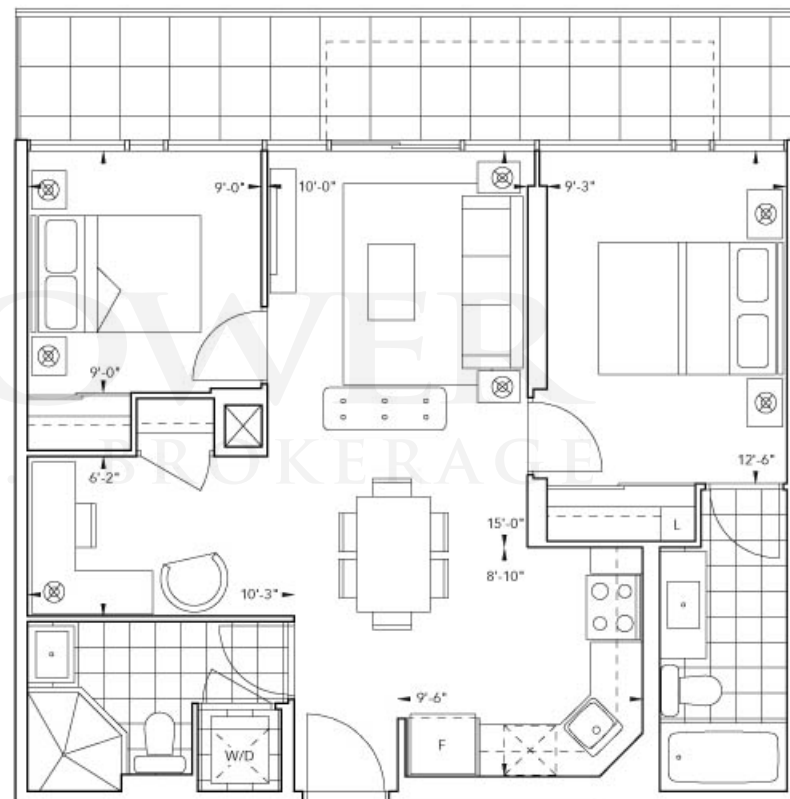

All dimensions are approximate and subject to normal construction variations. Dimensions may exceed the usability floor area. Show and model features are subject to change without notice. Furniture is depicted for illustrative purposes only and does not necessarily reflect the electrical plan for the unit. Sales are sold pursuant to E.S.C.E. October 16, 2019.

2A1+DT

This suite features 2 bedrooms, 2 bathrooms and a dynamic L-shaped kitchen layout that maximizes counter space and floor space. You also get a generous open area that could be configured several different ways, with enough room for a dining room, living room and den.

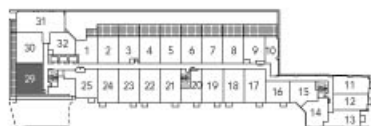

2ND FLOOR



LANDPOWER
REAL ESTATE LTD. BROKERAGE

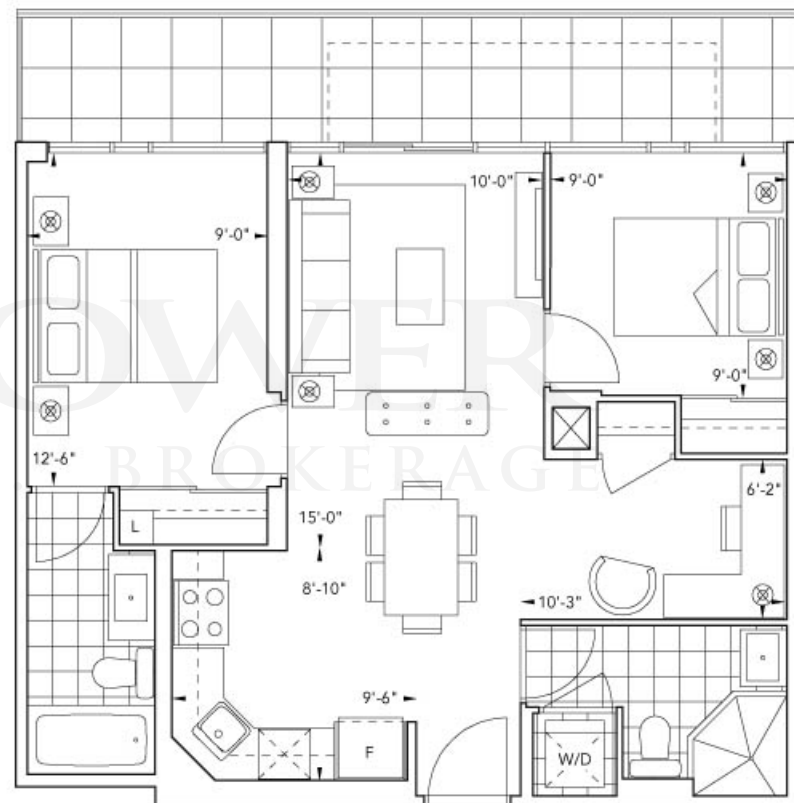

All dimensions are approximate and subject to normal construction variations. Dimensions may increase from visible floor area. View and/or features are subject to change without notice. Furniture is depicted for illustrative purposes only and does not necessarily reflect the actual layout for the suite. Suite is sold as indicated E.S.O.L. October 16, 2019

With a terrace almost as large as the interior space, this suite is destined to become an entertainment headquarters. And from ten stories high, you'll be treated to stunning views westward of the lake and the city.

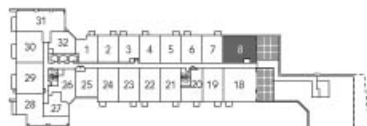

18TH FLOOR



LANDPOV
REAL ESTATE LTD. BROKERAGE

2B+T

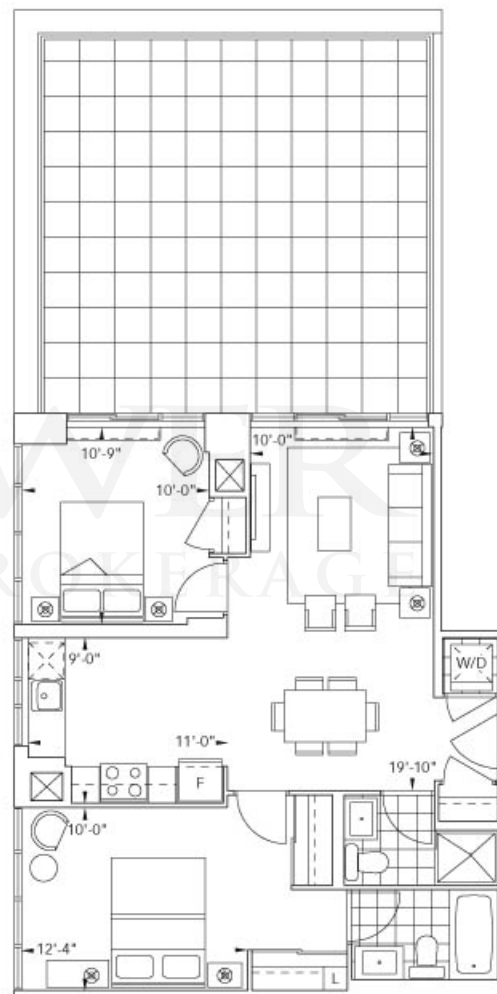

All dimensions are approximate and subject to normal construction variations. Dimensions may increase from usability floor area. Show and/or fixtures are subject to change without notice. Furniture is depicted for illustrative purposes only and does not necessarily reflect the actual layout for the unit. Photos are not published E.S.O.E. October 16, 2019

This spacious 2-bedroom suite features a master bedroom with ensuite bathroom, and a second bedroom with an extra-large shower and excellent counter space. This generously sized den is another value-added feature, in the perfect location to create a home office.

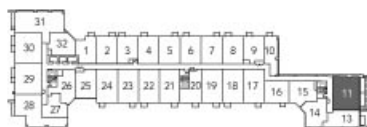

5TH FLOOR



LANDPOWER
REAL ESTATE LTD. BROKER/AGENT

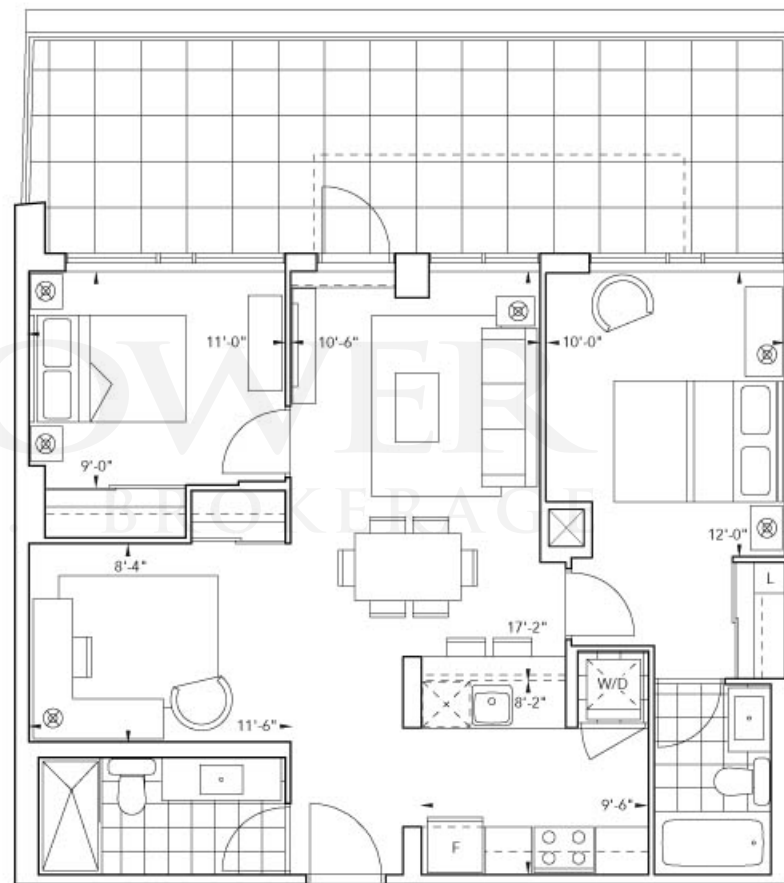

This unique layout features an expansive master bedroom with a walk-in closet and an ensuite bathroom. The other 2 bedrooms in the suite are treated to warming south views, and one of these rooms even has its own access to the spacious terrace.

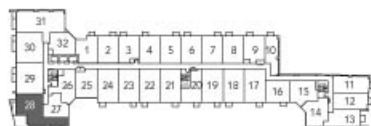

3RD FLOOR



LANDPOWER
REAL ESTATE LTD. BROKERAGE

3A1



All dimensions are approximate and subject to normal construction variations. Dimensions may increase from outside floor area. Show and/or final finishes are subject to change without notice. Furniture is depicted for illustrative purposes only and does not necessarily reflect the actual layout for the suite. Photos are not published E.S.O.E. October 16, 2011

With a charming balcony off the master bedroom and an enormous terrace on the north end of the suite, there will be no shortage of opportunities to relax or entertain outside in comfort and style. The central kitchen is another appealing feature, with enough countertop space for all your kitchen countertop appliances.



10TH FLOOR



LANDPOW
REAL ESTATE LTD. BROKER/AGENT

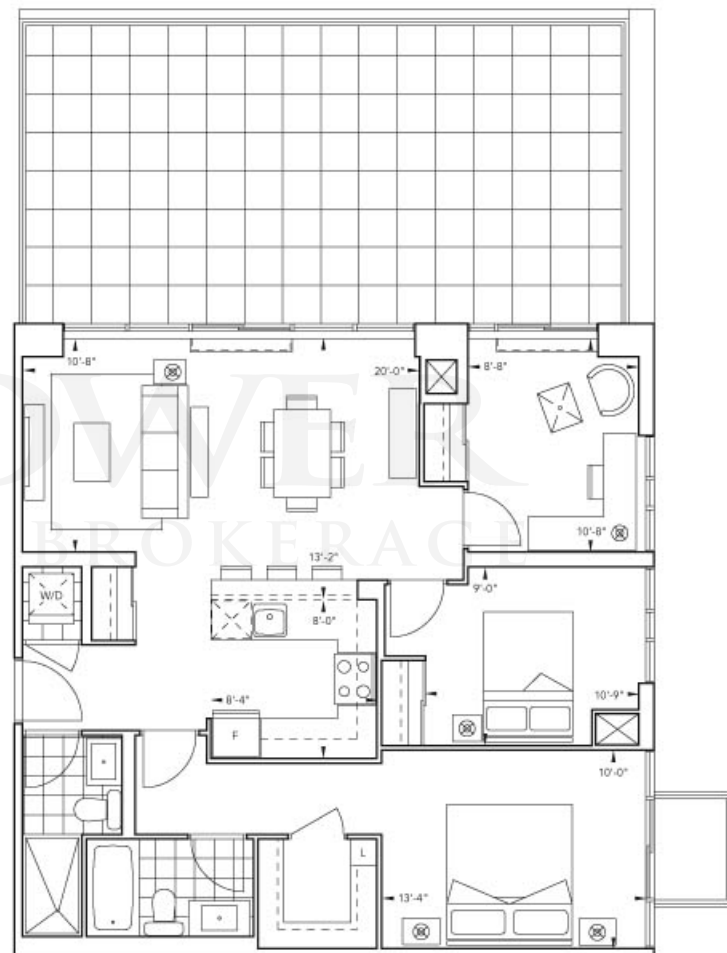

All dimensions are approximate and subject to normal construction variations. Dimensions may exceed the usable floor area. Show and/or photos are subject to change without notice. Furniture is depicted for illustrative purposes only and does not necessarily reflect the actual layout for the unit. Photos are not published E.S.C.E. October 16, 2019

Take life outside and relax on this 3-bedroom suite's oversized terrace. And while the master bedroom has a large walk-in closet and ensuite bathroom, the balcony attached to the second bedroom is an equally compelling room to call your own.



11TH FLOOR



LANDPOWER
REAL ESTATE LTD. BROKERAGE

3D+T

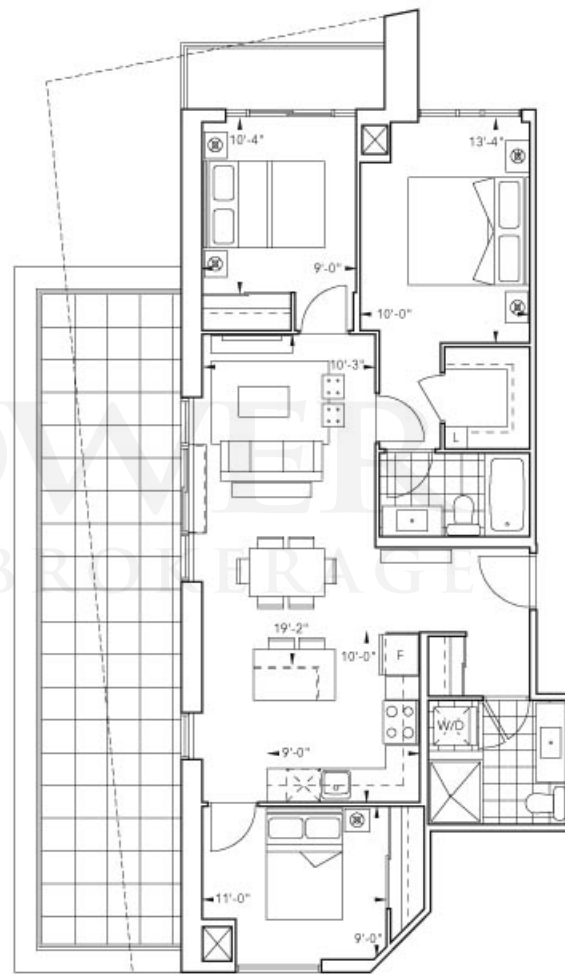

All dimensions are approximate and subject to normal construction variations. Dimensions may increase from usability. Floor area, flow and grid pattern is subject to change without notice. Furniture is depicted for illustrative purposes only and does not necessarily reflect the actual layout for the suite. Photos are not to scale. October 16, 2019

This 3-bedroom design features numerous floor-to-ceiling windows along the west wall for an abundance of natural light. The expansive terrace is another excellent feature, with entry points from the living room and the second bedroom.



11TH FLOOR



LANDPOVER
REAL ESTATE LTD. BROKER/AGENT

3E+T

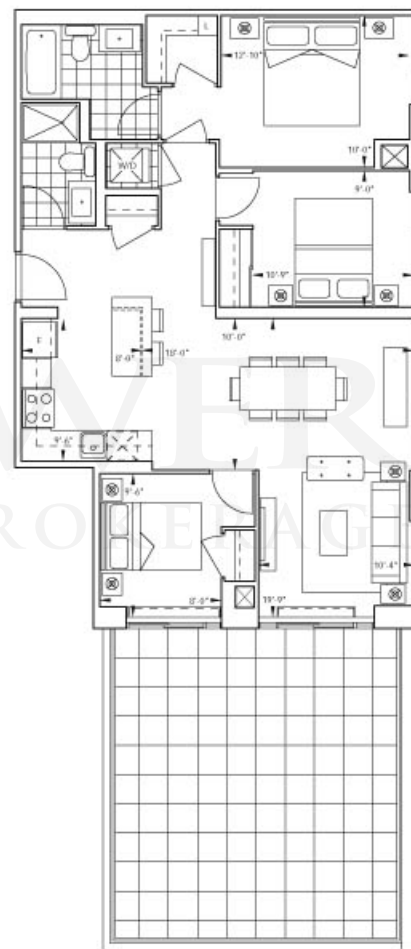

All dimensions are approximate and subject to normal construction variations. Dimensions may increase from outside floor area. Show and/or fixtures subject to change without notice. Furniture is depicted for illustrative purposes only and does not necessarily reflect the actual layout for the unit. Photos are not intended to be used for advertising purposes.

While the luxurious master bedroom features a large ensuite bathroom and amply sized walk-in closet, the bedroom next to the master runs a close second with its own balcony. The breakfast island is another wonderful feature of this 3-bedroom design.



11TH FLOOR



LANDPOWER
REAL ESTATE LTD. BROKERAGE

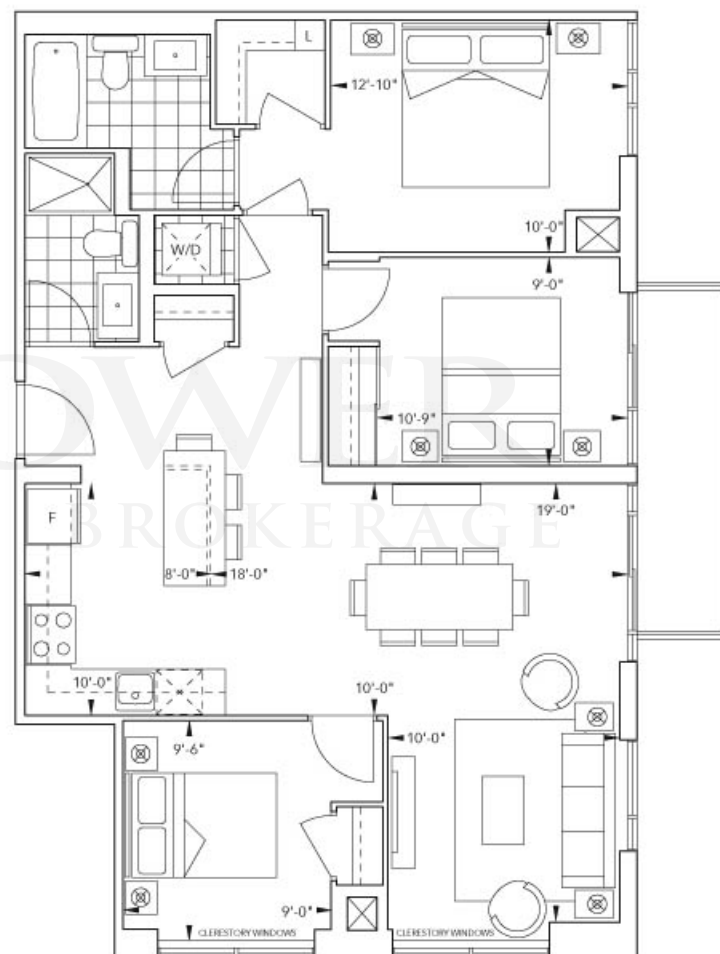

All dimensions are approximate and subject to normal construction variations. Dimensions may increase from outside floor area. Show and/or fixtures subject to change without notice. Furniture is depicted for illustrative purposes only and does not necessarily reflect the actual layout for the unit. Full plan and information available at 1.800.461.2891.

Two spacious balconies are a signature of this suite design, with each balcony offering ample room for a couple of patio chairs and a table. With floor-to-ceiling windows practically covering two walls, this promises to be a wonderfully inviting suite.



PENTHOUSE



LANDPOVER
REAL ESTATE LTD. BROKER



All dimensions are approximate and subject to normal construction variations. Dimensions may exceed the usable floor area. Show and/or photos are subject to change without notice. Furniture is depicted for illustrative purposes only and does not necessarily reflect the electrical plan for the suite. Photos are not intended to be used for advertising purposes. © 2018

There could be more windows than walls in this elegant 3-bedroom design. And from the twelfth floor, expect breathtaking views of the lake from the expansive terrace and balcony.



12TH FLOOR



LANDPOWER
REAL ESTATE LTD. BROKERAGE

3G+T

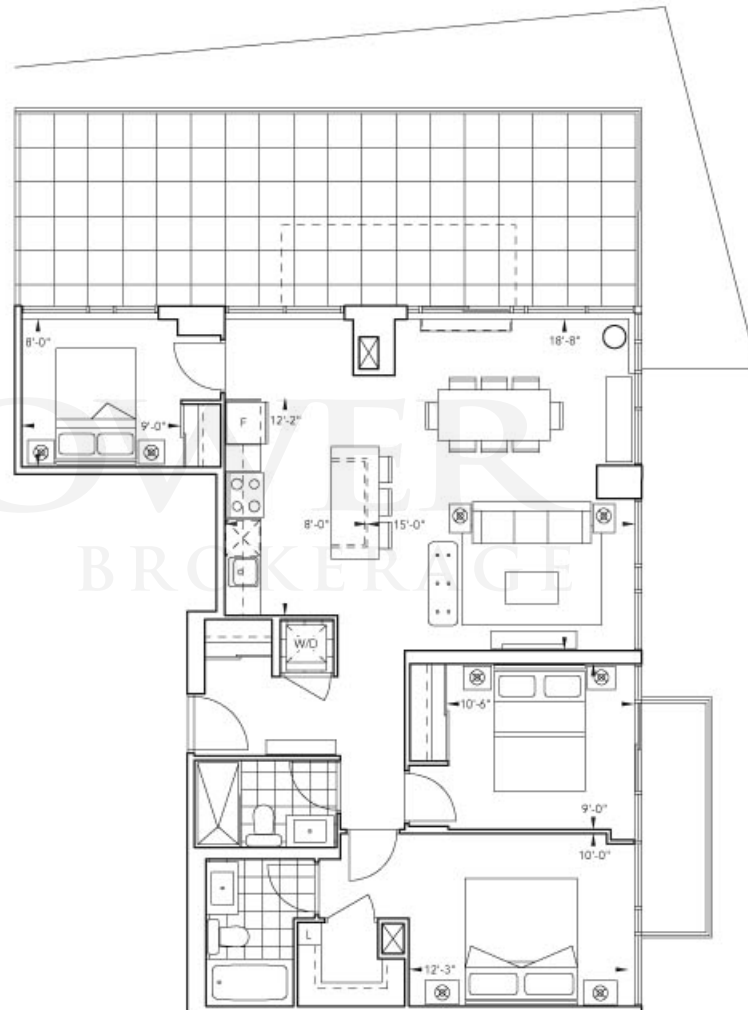

All dimensions are approximate and subject to normal construction variations. Dimensions may increase from outside floor area. Show and/or floor plans subject to change without notice. Furniture is depicted for illustrative purposes only and does not necessarily reflect the actual layout for the unit. Sales are sold as indicated E.S.C. October 16, 2019

Live large in this spacious 3 bedroom suite, featuring an amply sized living and dining area, and an exceptionally wide master bedroom. A kitchen island, a den at the home's entrance, and a balcony off two of the bedrooms are other exciting comforts built into this highly desirable suite.



14TH FLOOR



LANDPOVER
REAL ESTATE LTD BROKERAGE

3H+D



All dimensions are approximate and subject to normal construction variations. Dimensions may increase from visible floor area. Show and/or photos are subject to change without notice. Furniture is depicted for illustrative purposes only and does not necessarily reflect the actual layout for the suite. Full disclosure E.S.C.E. October 16, 2019

This intelligently designed suite has an extremely logical layout, with the 3 bedrooms positioned to offer maximum privacy while the grand living space encourages sociability. The private balconies off 2 of the bedrooms is another exciting feature.



PENTHOUSE



LANDPOVER
REAL ESTATE LTD. BROKERAGE

3H1+D

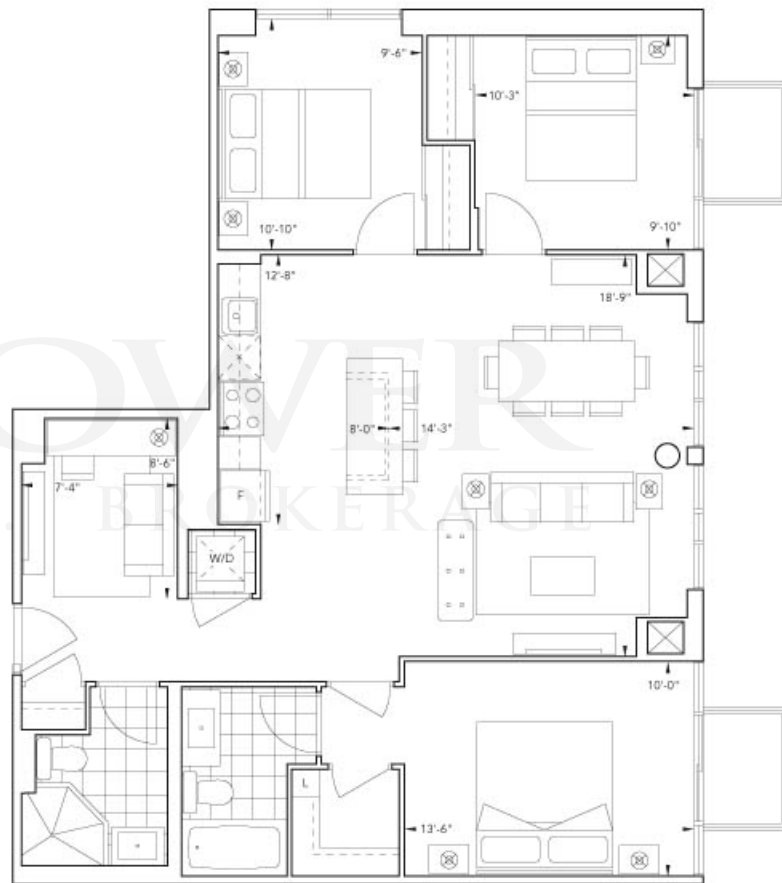

All dimensions are approximate and subject to normal construction variations. Dimensions may increase from visible floor area. Show and model pictures are subject to change without notice. Furniture is displayed for illustrative purposes only and does not necessarily reflect the actual layout for the suite. Photos are not published E.S.O.E. October 16, 2019

3J+T

The expansive master bedroom in this uniquely configured suite is wide enough for a king-size bed, has a generous walk-in closet with railings and shelves on three sides, and an enormous ensuite bathroom with "his" and "hers" sinks. And there's still lots of space remaining for everyone to spread out in this palatial 3-bedroom design.



11TH FLOOR



LANDPOWER
REAL ESTATE LTD. BROKERAGE

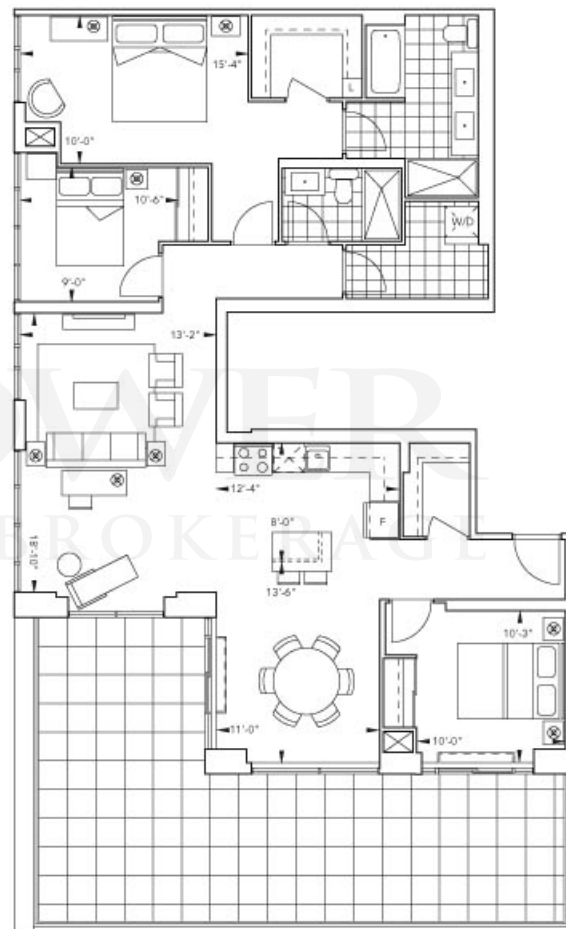

All dimensions are approximate and subject to normal construction variations. Dimensions may increase from outside floor area. Show and plan features are subject to change without notice. Furniture is depicted for illustrative purposes only and does not necessarily reflect the actual layout for the unit. Photos are not intended to be used for advertising purposes. © 2011



LANDPOWER

ESSENTIAL TRIDEL

REAL ESTATE LTD. BROKERAGE